

Panel	Effective Date	Panel	Effective Date	Panel	Effective Date
0050E	February 17, 2010	1950E	February 17, 2010	3700E	February 17, 2010
0075E	February 17, 2010	1975E	February 17, 2010	3725E	February 17, 2010
0100E	February 17, 2010	2000E	February 17, 2010	3750E	February 17, 2010
0125E	February 17, 2010	2025E	February 17, 2010	3775E	February 17, 2010
0150E	February 17, 2010	2050E	February 17, 2010	3800E	February 17, 2010
0175E	February 17, 2010	2075E	February 17, 2010	3825E	February 17, 2010
0200E	February 17, 2010	2100E	February 17, 2010	3850E	February 17, 2010
0225E	February 17, 2010	2125E	February 17, 2010	3875E	February 17, 2010
0250E	February 17, 2010	2150E	February 17, 2010	3900E	February 17, 2010
0275E	February 17, 2010	2175E	February 17, 2010	3925E	February 17, 2010
0300E	February 17, 2010	2200E	February 17, 2010	3950E	February 17, 2010
0325E	February 17, 2010	2225E	February 17, 2010	4025E	February 17, 2010
0350E	February 17, 2010	2250E	February 17, 2010	4050E	February 17, 2010
0375E	February 17, 2010	2275E	February 17, 2010	4075E	February 17, 2010
0400E	February 17, 2010	2300E	February 17, 2010	4100E	February 17, 2010
0425E	February 17, 2010	2325E	February 17, 2010	4125E	February 17, 2010
0450E	February 17, 2010	2350E	February 17, 2010	4150E	February 17, 2010
0475E	February 17, 2010	2375E	February 17, 2010	4175E	February 17, 2010
0500E	February 17, 2010	2400E	February 17, 2010	4200E	February 17, 2010
0525E	February 17, 2010	2425E	February 17, 2010	4225E	February 17, 2010
0550E	February 17, 2010	2450E	February 17, 2010	4250E	February 17, 2010
0575E	February 17, 2010	2475E	February 17, 2010	4275E	February 17, 2010
0600E	February 17, 2010	2500E	February 17, 2010	4300E	February 17, 2010
0625E	February 17, 2010	2525E	February 17, 2010	4325E	February 17, 2010
0650E	February 17, 2010	2550E	February 17, 2010	4350E	February 17, 2010
0675E	February 17, 2010	2575E	February 17, 2010	4375E	February 17, 2010
0700E	February 17, 2010	2600E	February 17, 2010	4400E	February 17, 2010
0725E	February 17, 2010	2625E	February 17, 2010	4425E	February 17, 2010
0750E	February 17, 2010	2650E	February 17, 2010	4450E	February 17, 2010
0775E	February 17, 2010	2675E	February 17, 2010	4475E	February 17, 2010
0800E	February 17, 2010	2700E	February 17, 2010	4500E	February 17, 2010
0825E	February 17, 2010	2725E	February 17, 2010	4525E	February 17, 2010
0850E	February 17, 2010	2750E	February 17, 2010	4550E	February 17, 2010
0875E	February 17, 2010	2775E	February 17, 2010	4575E	February 17, 2010
0900E	February 17, 2010	2800E	February 17, 2010	4600E	February 17, 2010
0925E	February 17, 2010	2825E	February 17, 2010	4625E	February 17, 2010
0950E	February 17, 2010	2850E	February 17, 2010	4650E	February 17, 2010
0975E	February 17, 2010	2875E	February 17, 2010	4675E	February 17, 2010
1000E	February 17, 2010	2900E	February 17, 2010	4700E	February 17, 2010
1025E	February 17, 2010	2925E	February 17, 2010	4725E	February 17, 2010
1050E	February 17, 2010	2950E	February 17, 2010	4750E	February 17, 2010
1075E	February 17, 2010	2975E	February 17, 2010	4775E	February 17, 2010
1100E	February 17, 2010	3000E	February 17, 2010	4800E	February 17, 2010
1125E	February 17, 2010	3025E	February 17, 2010	4825E	February 17, 2010
1150E	February 17, 2010	3050E	February 17, 2010	4850E	February 17, 2010
1175E	February 17, 2010	3075E	February 17, 2010	4875E	February 17, 2010
1200E	February 17, 2010	3100E	February 17, 2010	4900E	February 17, 2010
1225E	February 17, 2010	3125E	February 17, 2010	4925E	February 17, 2010
1250E	February 17, 2010	3150E	February 17, 2010	4950E	February 17, 2010
1275E	February 17, 2010	3175E	February 17, 2010	4975E	February 17, 2010
1300E	February 17, 2010	3200E	February 17, 2010	5000E	February 17, 2010
1325E	February 17, 2010	3225E	February 17, 2010	5025E	February 17, 2010
1350E	February 17, 2010	3250E	February 17, 2010	5050E	February 17, 2010
1375E	February 17, 2010	3275E	February 17, 2010	5075E	February 17, 2010
1400E	February 17, 2010	3300E	February 17, 2010	5100E	February 17, 2010
1425E	February 17, 2010	3325E	February 17, 2010	5125E	February 17, 2010
1450E	February 17, 2010	3350E	February 17, 2010	5150E	February 17, 2010
1475E	February 17, 2010	3375E	February 17, 2010	5175E	February 17, 2010
1500E	February 17, 2010	3400E	February 17, 2010	5200E	February 17, 2010
1525E	February 17, 2010	3425E	February 17, 2010	5225E	February 17, 2010
1550E	February 17, 2010	3450E	February 17, 2010	5250E	February 17, 2010
1575E	February 17, 2010	3475E	February 17, 2010	5275E	February 17, 2010
1600E	February 17, 2010	3500E	February 17, 2010	5300E	February 17, 2010
1625E	February 17, 2010	3525E	February 17, 2010	5325E	February 17, 2010
1650E	February 17, 2010	3550E	February 17, 2010	5350E	February 17, 2010
1675E	February 17, 2010	3575E	February 17, 2010	5375E	February 17, 2010
1700E	February 17, 2010	3600E	February 17, 2010	5400E	February 17, 2010
1725E	February 17, 2010	3625E	February 17, 2010	5425E	February 17, 2010
1750E	February 17, 2010	3650E	February 17, 2010	5450E	February 17, 2010
1775E	February 17, 2010	3675E	February 17, 2010	5475E	February 17, 2010
1800E	February 17, 2010	3700E	February 17, 2010	5500E	February 17, 2010
1825E	February 17, 2010	3725E	February 17, 2010	5525E	February 17, 2010
1850E	February 17, 2010	3750E	February 17, 2010	5550E	February 17, 2010
1875E	February 17, 2010	3775E	February 17, 2010	5575E	February 17, 2010
1900E	February 17, 2010	3800E	February 17, 2010	5600E	February 17, 2010
1925E	February 17, 2010	3825E	February 17, 2010	5625E	February 17, 2010

* PANEL NOT PRINTED -NO SPECIAL FLOOD HAZARD AREAS
 ** PANEL NOT PRINTED -TOIYABE NATIONAL FOREST, HUMBOLDT NATIONAL FOREST, NELLIS AIR FORCE RANGE, NEVADA TEST SITE, & DEATH VALLEY NATIONAL PARK ZONE D
 *** PANEL NOT PRINTED -TOIYABE NATIONAL FOREST, HUMBOLDT NATIONAL FOREST, NELLIS AIR FORCE RANGE, NEVADA TEST SITE, & DEATH VALLEY NATIONAL PARK ZONE D; REST OF PANEL NO SPECIAL FLOOD HAZARD AREAS

MAP REPOSITORIES

NYE COUNTY
 UNINCORPORATED AREAS
 Nye County Department of Planning
 1114 Globe Mallow
 P.O. Box 1531
 Tonopah, NV 89049

ELEVATION DATUM

Flood elevations on this map are referenced to the North American Vertical Datum of 1988. These flood elevations must be compared to structure and ground elevations referenced to the same datum. For information regarding conversion between the National Geodetic Vertical Datum of 1929 and the North American Vertical Datum of 1988, contact the National Geodetic Survey at the following address:
 NGS Information Services
 NOAA, NNGS12
 National Geodetic Survey
 SSMC-3, #9202
 1315 East-West Highway
 Silver Spring, MD 20910-3282
 (301) 713-3242

BASE MAP SOURCE

Base map information shown on this FIRM was derived from multiple sources. Base map data were provided in digital format by Nye County. This information was compiled using source materials dated 2008. Additional information was photogrammetrically compiled at a scale of 1:12000 from aerial photography dated 2006.

LISTING OF COMMUNITIES

COMMUNITY NAME	COMMUNITY NUMBER	LOCATED ON PANELS	INITIAL NFIP MAP DATE	INITIAL FIRM DATE	MOST RECENT FIRM PANEL DATE
NYE COUNTY (UNINCORPORATED AREAS)	320018	0025*, 0050, 0075, 0100*, 0125, 0150, 0175*, 0200, 0225, 0250*, 0275*, 0300*, 0325, 0350, 0375*, 0400, 0425, 0450, 0475, 0500, 0525*, 0550, 0575, 0600, 0625, 0650*, 0675*, 0700, 0725, 0750*, 0775*, 0800*, 0825, 0850*, 0875*, 0900, 0925, 0950, 0975*, 1000, 1025, 1050, 1075*, 1100, 1125*, 1150, 1175, 1200*, 1225*, 1250, 1275*, 1300, 1325, 1350, 1375, 1400, 1425*, 1450, 1475, 1500*, 1525*, 1550*, 1575, 1600, 1625*, 1650, 1675, 1700, 1725*, 1750*, 1775*, 1800*, 1825, 1850, 1875*, 1900, 1925, 1950, 1975, 2000, 2025*, 2050, 2075, 2100, 2125*, 2150, 2175*, 2200, 2225, 2250, 2275*, 2300*, 2325*, 2350*, 2375*, 2400*, 2425, 2450, 2475*, 2500, 2525*, 2550, 2575, 2600, 2625*, 2650, 2675, 2700, 2725*, 2750, 2775, 2800*, 2825, 2850, 2875*, 2900, 2925, 2950*, 2975, 3000, 3025*, 3050, 3075, 3100, 3125, 3150, 3175*, 3200, 3225, 3250, 3275*, 3300*, 3325, 3350, 3375, 3400, 3425, 3450, 3475*, 3500, 3525, 3550, 3575*, 3600, 3625*, 3650, 3675, 3700, 3725, 3750, 3775, 3800, 3825*, 3850*, 3875, 3900, 3925*, 3950, 3975*, 4000*, 4025, 4050, 4075*, 4100, 4125, 4150*, 4175, 4200, 4225*, 4250, 4275, 4300*, 4325*, 4350*, 4375*, 4400, 4425, 4450, 4475*, 4500*, 4525, 4550*, 4575*, 4600*, 4625*, 4650*, 4675, 4700, 4725, 4750*, 4775*, 4800*, 4825*, 4850*, 4875*, 4900, 4925, 4950*, 4975, 5000, 5025*, 5050*, 5075, 5100*, 5125*, 5150, 5175*, 5200, 5225*, 5250*, 5275*, 5300*, 5325*, 5350*, 5375*, 5400, 5425, 5450, 5475, 5500, 5525, 5550*, 5575*, 5600, 5625, 5650, 5675*, 5700*, 5725, 5750*, 5775*, 5800*, 5825*, 5850*, 5875*, 5900, 5925, 5950*, 5975, 6000*, 6025*, 6050*, 6075*, 6100*, 6125*, 6150*, 6175*, 6200*, 6225, 6250, 6275, 6300*, 6325*, 6350*, 6375*, 6400*, 6425*, 6450*, 6475*, 6500, 6525, 6550, 6575*, 6600*, 6625*, 6650*, 6675*, 6700*, 6725*, 6750*, 6775*, 6800*, 6825, 6850*, 6875*, 6900*, 6925*, 6950*, 6975*, 7000*, 7025*, 7050*, 7075*, 7100*, 7125*, 7150, 7175*, 7200*, 7225*, 7250*, 7275*, 7300*, 7325*, 7350*, 7375*, 7400*, 7425, 7450, 7475, 7500*, 7525*, 7550*, 7575*, 7600*, 7625*, 7650*, 7675*, 7695, 7700*, 7715, 7725, 7750, 7775*, 7800*, 7825*, 7850*, 7875*, 7900*, 7925*, 7950, 7975, 8000, 8025*, 8050*, 8075*, 8100*, 8125*, 8150*, 8175, 8200, 8225, 8250*, 8275*, 8300*, 8325*, 8350*, 8375, 8400, 8425, 8450, 8475, 8500, 8525*, 8550, 8575, 8600, 8625*, 8650*, 8675*, 8700, 8725, 8750, 8775*, 8800, 8825, 8850, 8875, 8900	OCTOBER 18, 1974	APRIL 12, 1983	FEBRUARY 17, 2010

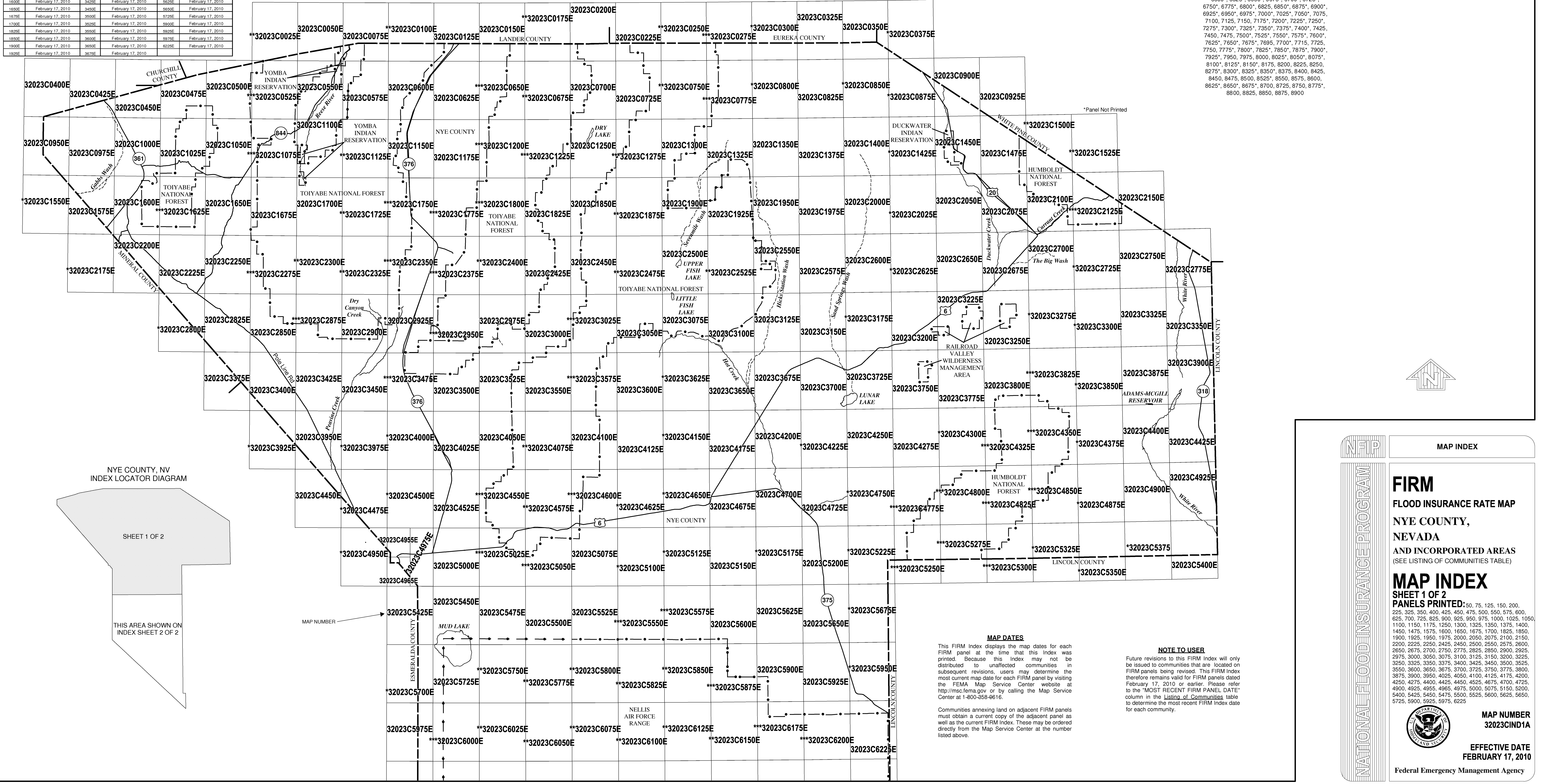

NYE COUNTY, NV
 INDEX LOCATOR DIAGRAM

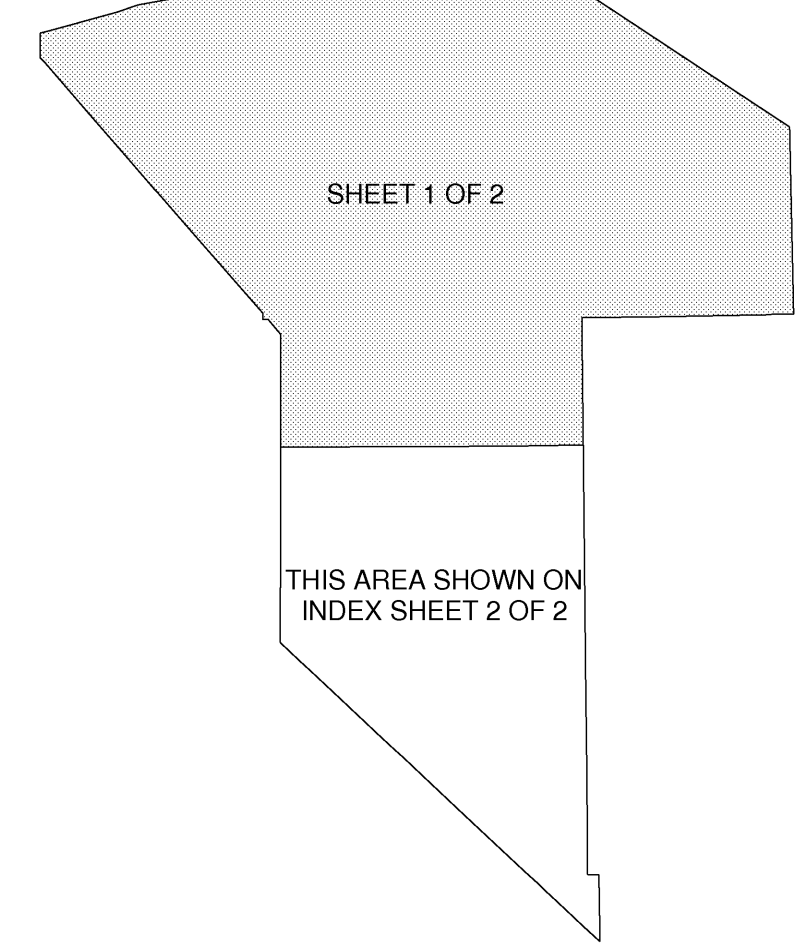

MAP DATES

This FIRM Index displays the map dates for each FIRM panel at the time that this Index was printed. Because this Index may not be distributed to unaffected communities in subsequent revisions, users may determine the most current map date for each FIRM panel by visiting the FEMA Map Service Center website at <http://msc.fema.gov> or by calling the Map Service Center at 1-800-358-6616.

NOTE TO USER

Future revisions to this FIRM Index will only be issued to communities that are located on FIRM panels being revised. This FIRM Index therefore remains valid for FIRM panels dated February 17, 2010 or earlier. Please refer to the "MOST RECENT FIRM PANEL DATE" column in the Listing of Communities table to determine the most recent FIRM Index date for each community.

Communities annexing land on adjacent FIRM panels must obtain a current copy of the adjacent panel as well as the current FIRM Index. These may be ordered directly from the Map Service Center at the number listed above.

NATIONAL FLOOD INSURANCE PROGRAM

MAP INDEX

FIRM
 FLOOD INSURANCE RATE MAP
 NYE COUNTY,
 NEVADA
 AND INCORPORATED AREAS
 (SEE LISTING OF COMMUNITIES TABLE)

MAP INDEX
 SHEET 1 OF 2
 PANELS PRINTED: 50, 75, 125, 150, 200, 225, 325, 350, 400, 425, 450, 475, 500, 550, 575, 600, 625, 700, 725, 825, 900, 925, 950, 975, 1000, 1025, 1050, 1100, 1150, 1175, 1250, 1300, 1325, 1350, 1375, 1400, 1450, 1475, 1575, 1600, 1650, 1675, 1700, 1825, 1850, 1900, 1925, 1950, 1975, 2000, 2050, 2075, 2100, 2150, 2200, 2225, 2250, 2425, 2450, 2500, 2550, 2575, 2600, 2650, 2675, 2700, 2750, 2775, 2825, 2850, 2900, 2925, 2975, 3000, 3050, 3075, 3100, 3125, 3150, 3200, 3225, 3250, 3325, 3350, 3375, 3400, 3425, 3450, 3500, 3525, 3550, 3600, 3650, 3675, 3700, 3725, 3750, 3775, 3800, 3875, 3900, 3950, 4025, 4050, 4100, 4125, 4175, 4200, 4250, 4275, 4400, 4425, 4450, 4525, 4575, 4675, 4700, 4725, 4900, 4925, 4955, 4985, 4975, 5000, 5075, 5150, 5200, 5400, 5425, 5450, 5475, 5500, 5525, 5600, 5625, 5650, 5725, 5900, 5925, 5975, 6225

MAP NUMBER
32023CIND1A

EFFECTIVE DATE
FEBRUARY 17, 2010

Federal Emergency Management Agency